

GANPAT UNIVERSITY

B. Tech. Semester: VIII Marine Engineering

Regular Examination April – June 2016

2MR805 MARINE MACHINERY SYSTEMS DESIGN

Time: 3 HRS

TOTAL MARKS: 70

- Instructions:**
- (1) Orthographic Projections are to be drawn using first angle projection.
 - (2) All dimensions in the drawing in mm.
 - (3) Where the dimensions are not given suitable dimensions can be given.
 - (4) Neatness in drawing carries Weightage.
 - (5) All the rough work should be done on a separate sheet which has to be submitted along with the drawing sheet.
 - (6) Scale chosen must be clearly indicated.

Q.1 Draw the following views of the Cylinder Relief Valve (as attached page no.02)

- (a) Elevation in section showing valve assembled.
- (b) End Elevation
- (c) Plan View

-----END OF PAPER-----

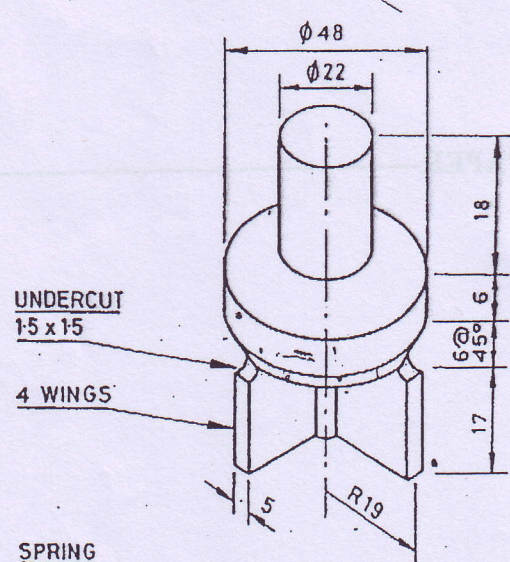
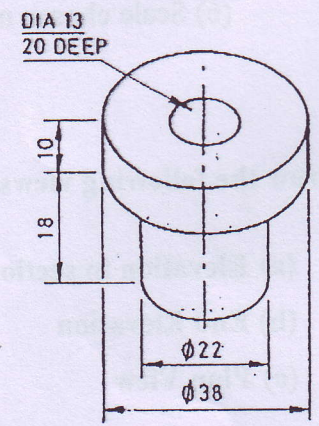
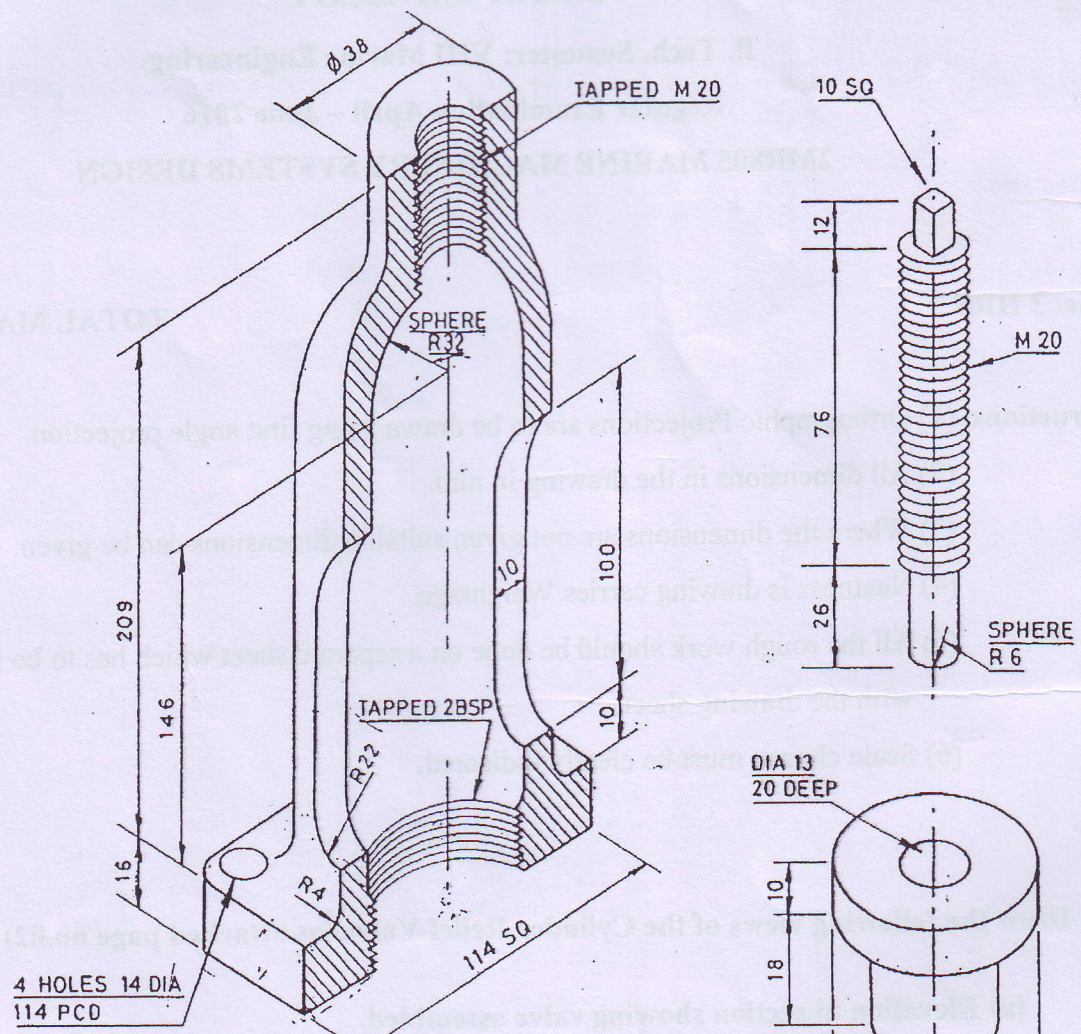

SPRING
 FREE LENGTH 146
 LENGTH COMPRESSED 127
 MEAN DIA 32
 DIA OF WIRE 8

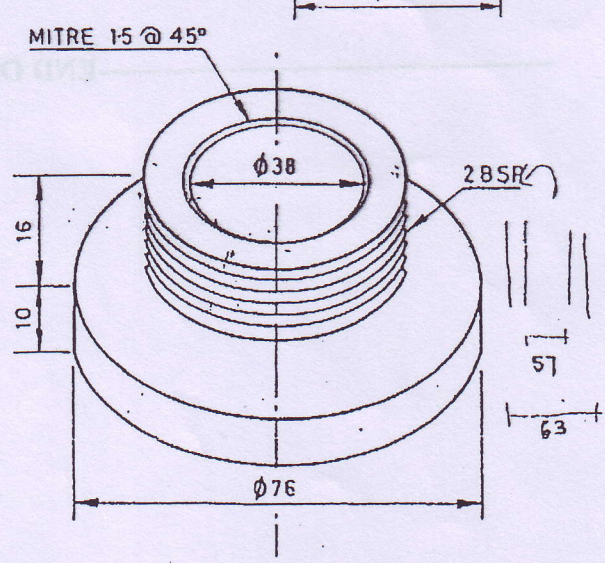

-----END OF PAPER-----